

Singuliers Pluriel

(Singulars plural)
Immersive and interactive
audiovisual installation

concept, creation : Jeannie Brie
curator : Vincent Verlé
scientific advisor : Olivier Aron

Distribution :
GRAVE
contact@supergrave.fr

www.supergrave.fr

TECHNICAL RIDER

Description :

It is an immersive and interactive audiovisual installation exploring the mechanisms of memory through family films. The system generates a real-time nonlinear audiovisual montage influenced by the movements of visitors. The control room is located in a small space made from a false wall of raw plywood, and it is visible and integrated into the space. All cables are visible and black. They run towards the control room and pass through the wall behind which it stands via a central hole.

SPACE REQUIRED:

Dark room
Ideal minimum surface area: 200 m²
Minimum ceiling height: 3.20 m

INSTALLATION DURATION:

Setup: 3 to 6 days (depending on the team)
Dismantling: 1 to 2 days

REQUIRED TECHNICAL TEAM:

The artist + 1 to 4 additional people (Venue and/or artistic team)

ELEMENTS OF THE INSTALLATION:

The installation consists of:

- 7 suspended projectors
- 6 freestanding projection screens (steel and wood)
- 1 curtain screen made of PVC strips
- 4 IP cameras directed at the objects
- 1 control room (7 computers + sound card + RJ45 switch)
- A small room made of raw plywood for the control room
- 6 speakers on stands
- Various objects (carafes, swings, games...) on stands

All elements of the installation are provided except for:

TO BE PROVIDED BY THE ORGANIZER:

- Dark room
- Additional cables for sound, video, and/or network (to be discussed in advance depending on the venue)
- Sufficiently long electrical extension cables to connect the control room to each electric elements
- Suspension systems for the 7 projectors
- 4 spotlight-type lights for the groups of objects

TRANSPORT:

The installation is transported in a utility vehicle (12 m³)

REMARKS:

The presence of the artist is necessary for installation and adjustments
The installation is adaptable based on the characteristics of the venue
Special attention must be paid to cable management (neural arrangement)

AVAILABILITY:

The installation is available for new exhibitions starting in June 2025.

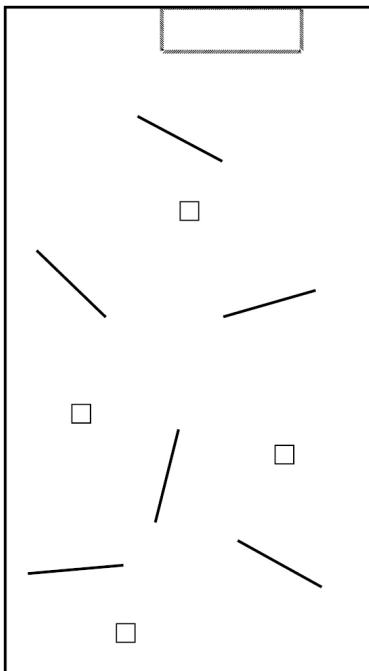

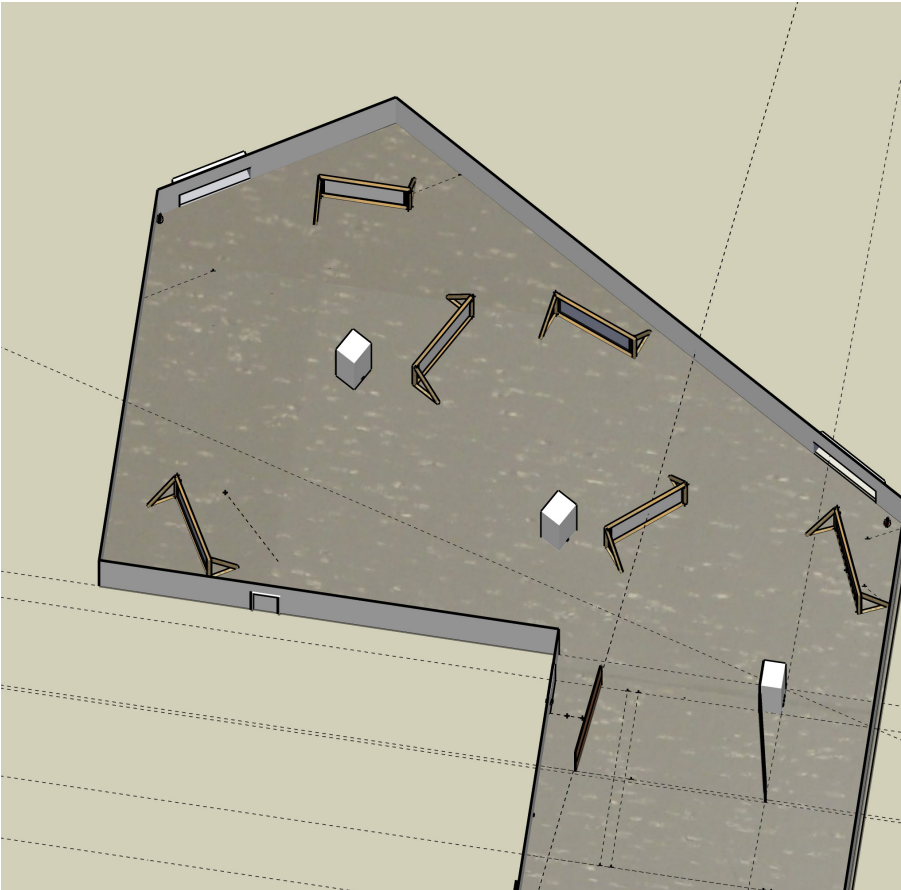
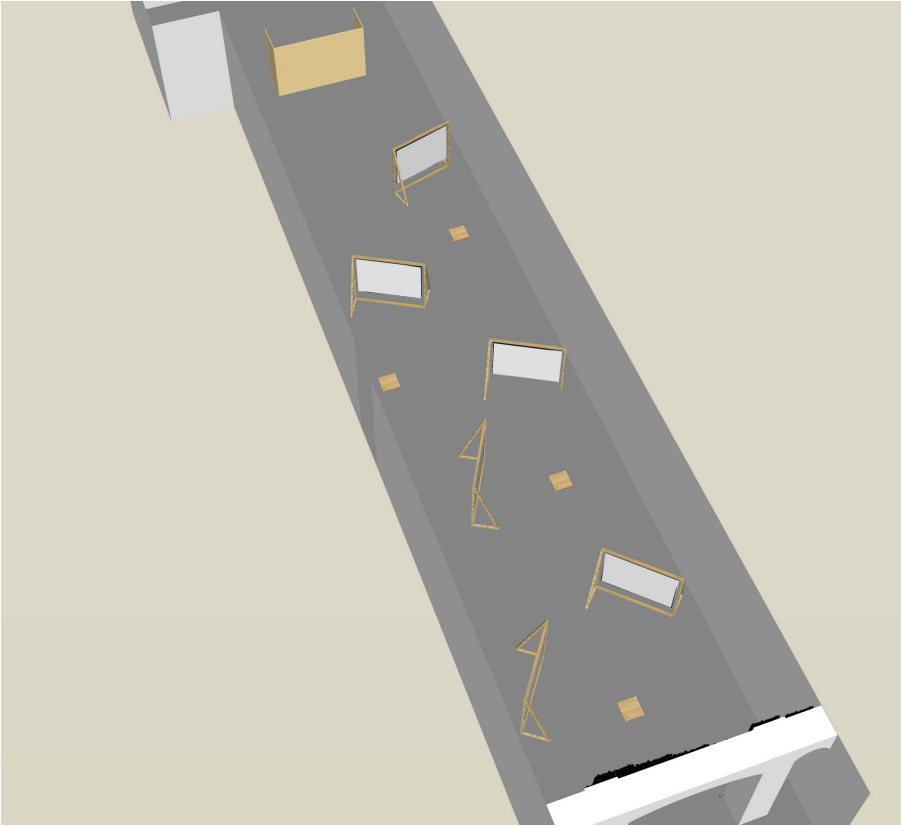

IMAGES : preparatory sketches for exhibition
Galerie Poirel, Nancy (HAUT) et au CCAM- vandœuvre les Nancy (BAS)