



# EIKASIA

**ABACO X DORIAN RIGAL MINUIT**

**TECHNICAL FILE**

# RIDER TECH

Éléments	Description	Quantité	Poids	Fournisseur
Vidéo projector	2xVP 12K lumens ou 2xVP 7K lumens (en fonction de l'espace)			Organisateur
Computer	rtx 1070 ou 2070 - Resolume installé			Organisateur
Net	4x400m - or more considering the space			Artiste
Chains	50m - or more considering the space			Artiste
Strap	100m - or more considering the space			Artiste
Truss structure	Considering the implantation			Organisateur
Nacelle	Électric - according to the height of the installation			Organisateur
Sound system	4 speakers - 1 subwoofer			Organisateur
Technical space	T table 2 chairs - 3x3m tent if outside - hdmi cables connected to the projecteurs			Organisateur



# SETUP OPTION

## BUILDING HALL

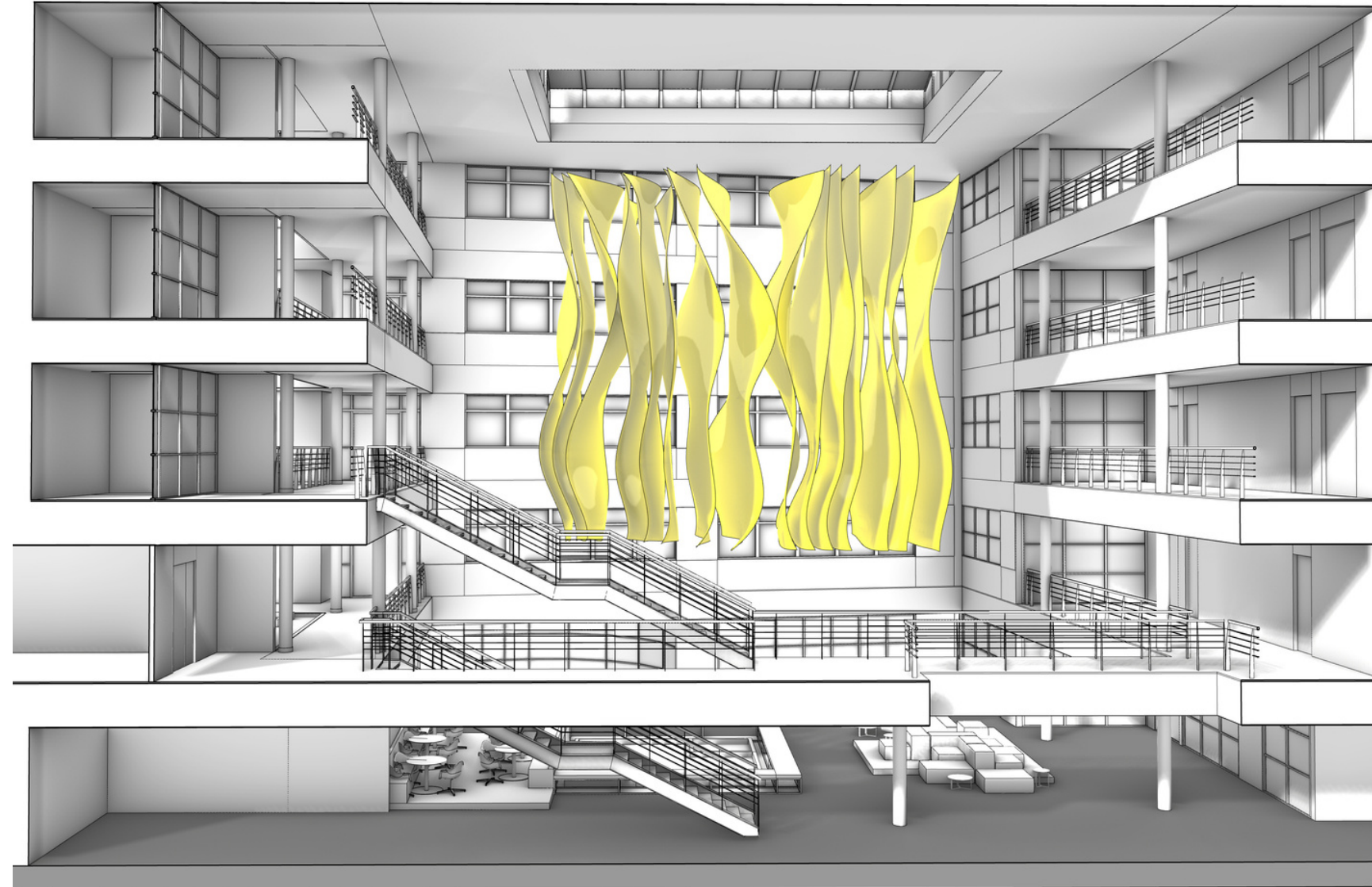

The net would be attached directly to the existing architecture while adapting to it and thus reducing the costs of installing a truss structure.

---

# SETUP OPTION

## BRIDGE / INDUSTRIAL SPACE

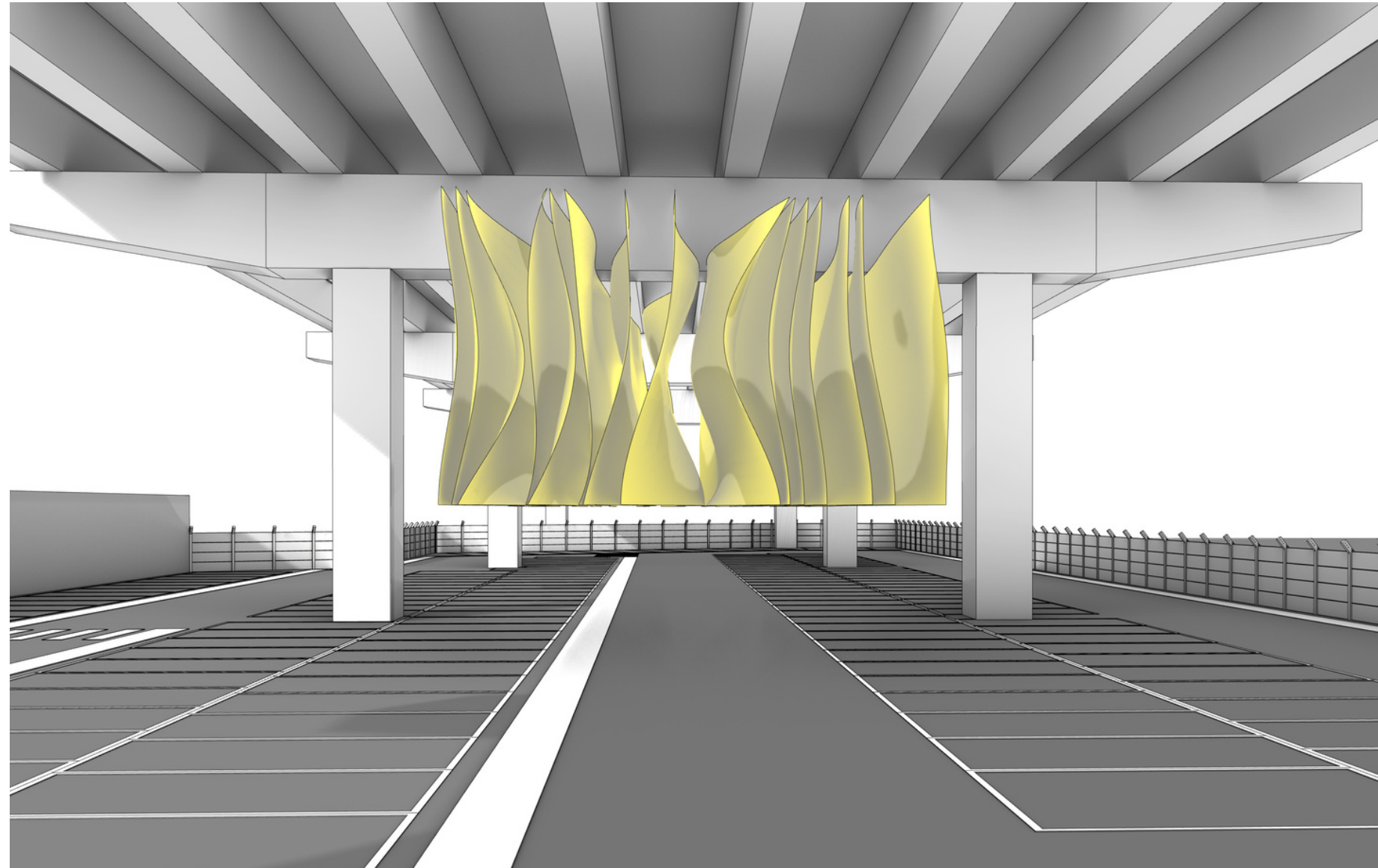

The net would be attached directly to the existing architecture while adapting to it and thus reducing the costs of installing a truss structure.

---

# SETUP OPTION

## COURTYARD / PUBLIC SQUARE



---

An open inner courtyard in which straps would be attached to the facades to create the attachment points for the net. The lightness of the net allows it to be attached in a way that respects the facades.



# SETUP OPTIONS

## ALLEY

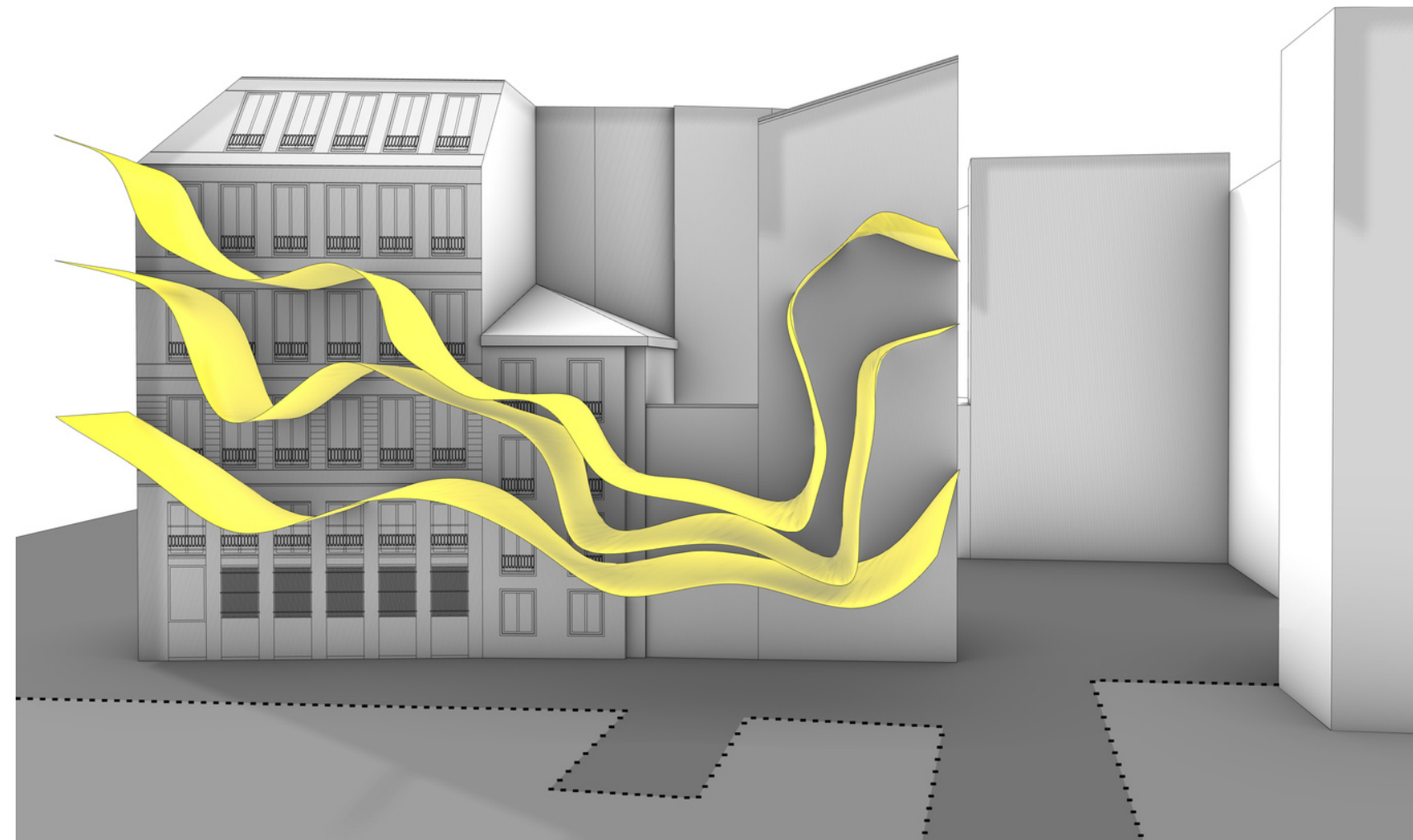

In a narrow alley, Eikasia traces the path of a new experience by anchoring herself directly to the facades, this time horizontally.

---

# PLANNING DE PRODUCTION

Date	Description	Besoins
D-4	Arrival of the artists and beginning of installation	Régisseur général + Matériel à la charge de l'organisateur dans le rider
D-4 à D-1	Installation	Régisseur général
D-1	Video and sound test in situ, no light or sound pollution	Régisseur général
D+1 à D+2	Deinstallation	Nacelle + Régisseur général

## MISE EN ROUTE & MAINTENANCE

Mise sous tension de l'ordinateur et vidéoprojecteur

Lancement du programme Resolume

Vérification de la sortie vidéo des projecteurs (projection sur l'oeuvre)

---

# BUDGET

## TRANSPORT MATERIEL

Détails

Poids

Truck 5m <sup>3</sup>	20kg
-----------------------	------

## CACHET

EXPOSITION	Dependent on the project
------------	--------------------------

## VHR

TRAIN	1st / 2nd class
PLANE	Legroom seat +
HÔTEL	3/4 stars
RESTAURATION	30€ per day







**PRODUCTION  
& DISTRIBUTION**  
36 DEGRÉS

**EIKASIA**  
ABACO x DORIAN RIGAL MINUIT

georges@36degres.art

06 50 09 08 13

