



contact +33 (0)7 69 54 71 93
gb@lacri.net

A#2-FLUX - TECHNICAL RIDER

GENERAL CONSIDERATION :

- black box
- tolerance 0 UV

TECHNICAL BACKLINE PROVIDE BY LA CRI TEAM

- Video-projector Full HD 3D (Epson EH-TW9200W or equivalent)
- 4 glasses for 3D
- 4 infra-red lasers
- 1 Infra-red camera
- 2 mac mini
- 1 sound card

TECHNICAL BACKLINE TO PROVIDE

- Box
- cheling screen + keyboard + mouse
- 4 audio speakers + 1 multichanel amp + 1 subwoofer
- riser
- support (metalic support - 4 foots)
- magic arm to hang the video-projector vertically

INSTALLATION :

The artist and the ingeneer need 2 days to install the all material of A#2-FLUX in the space with the technical team of the exhibition place.

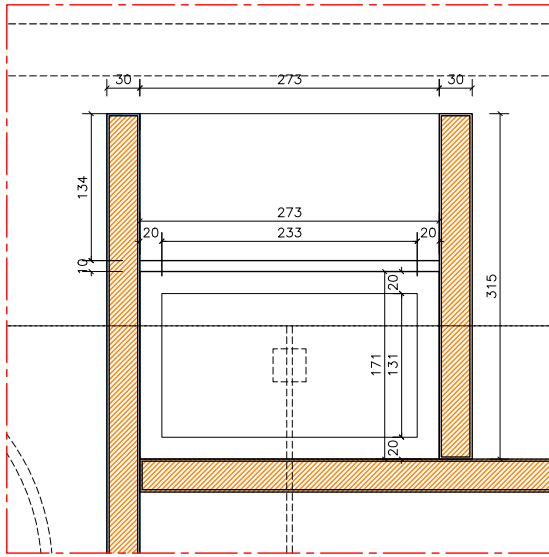

PLAN
ECH 1:50

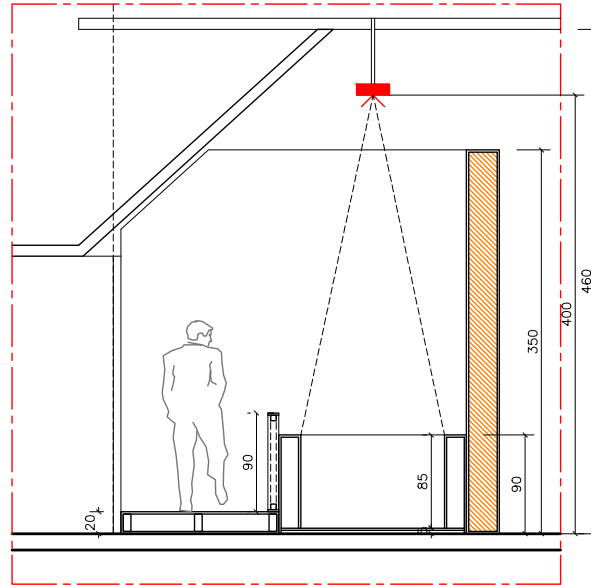

COUPE BB
ECH 1:50

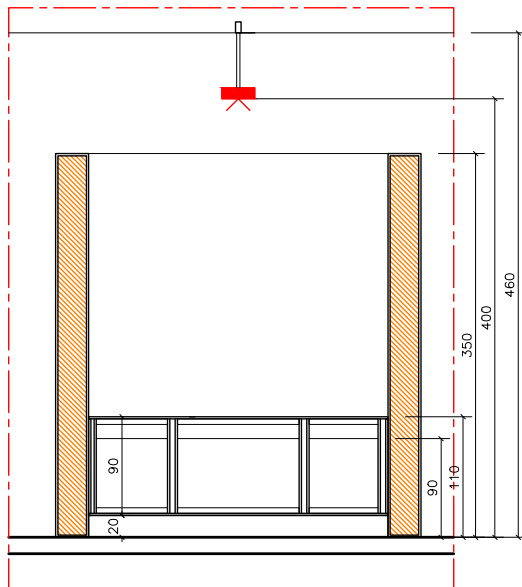

COUPE AA
ECH 1:50

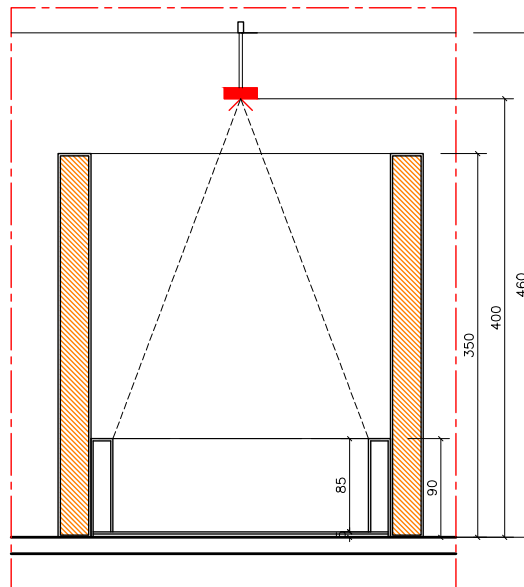

COUPE CC
ECH 1:50

PLAN A#2 FLUX

contact +33 (0)7 69 54 71 93
gb@lacri.net

Plan

A#2-FLUX

contact +33 (0)7 69 54 71 93
gb@lacri.net

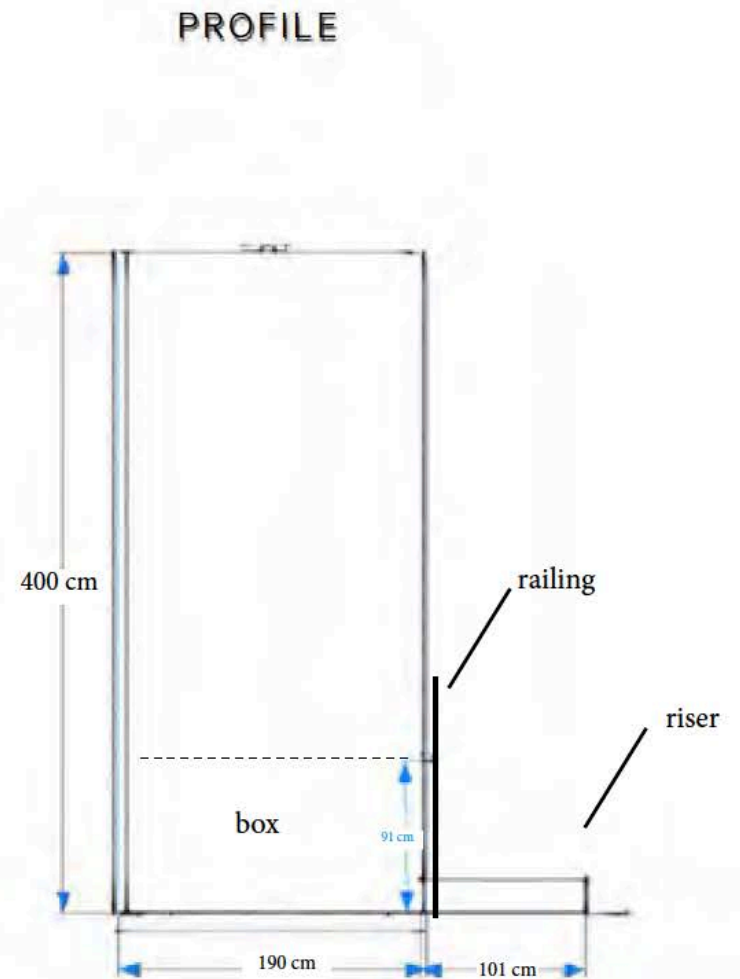
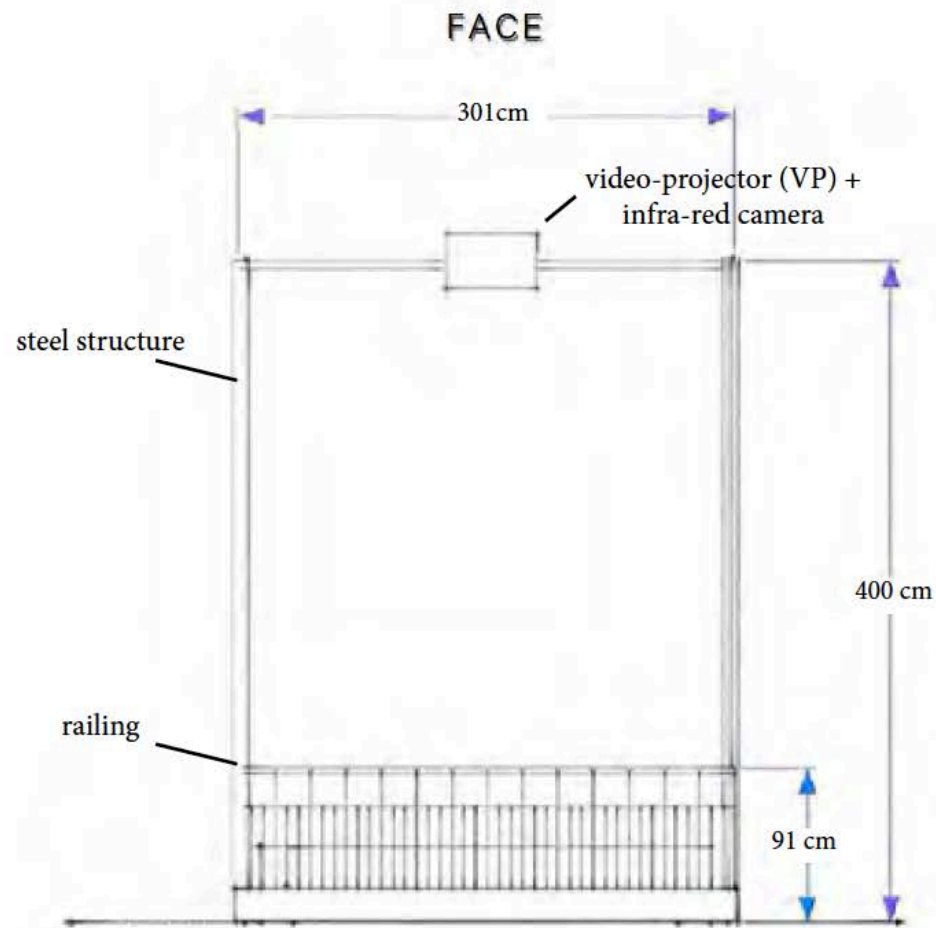



BOX A#2-FLUX

contact +33 (0)7 69 54 71 93
gb@lacri.net

PERSPECTIVE VIEW

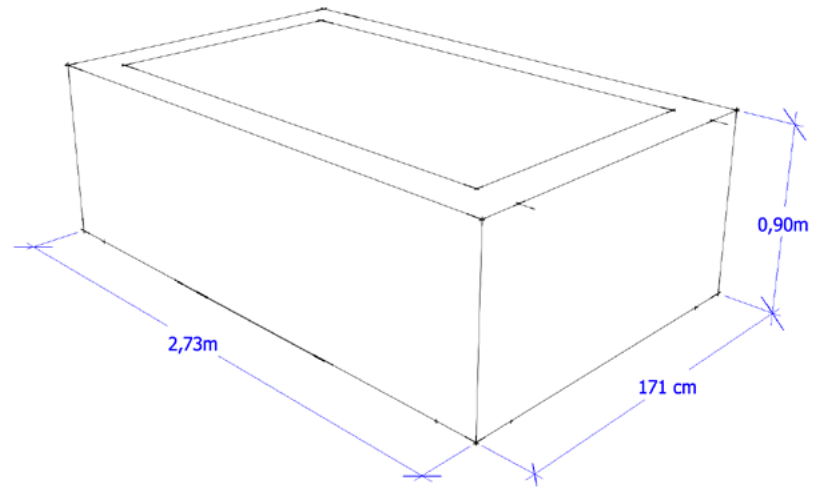

TOP VIEW

