

Painting Mirror

Typical Technical Sheet

PROJECTION WALL

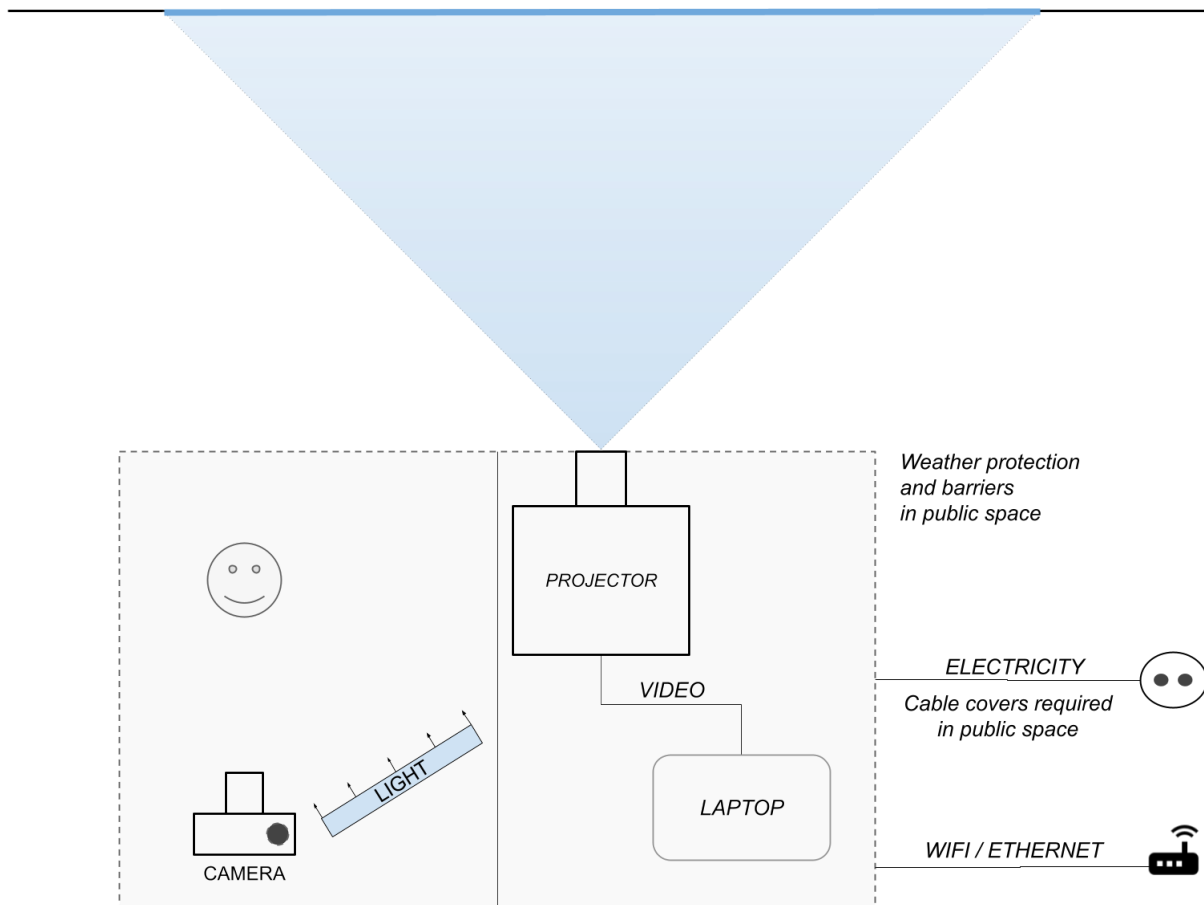

EQUIPMENT

Provided by the Painting Mirror Team

- Projector(s), power and lens adapted to location
- Video equipment : laptops, video cables
- (optional: Photobooth) Camera, Tripod, lights

To provide by the organizer (or rental on-site)

- Projector fixation adapted to location : truss tower, stage table, ...
- (optional: Photobooth) weather protection, background, more lights
- Tech : 1 table, 3 chairs, weather protections and vauban barriers if in public space
- Secured electrical access, extension cables, 5 sockets
- 5sqm of storage space in a secured location close to the projection site
- High speed internet (cable recommended)

PLANNING

As soon as possible

Location scouting with pictures, video call and ideally building/street plans. A physical location scouting can be necessary.

The day before show day

Equipment installation.

Projections tests and mapping : a 4 hour time slot, at the same hours as show hours if outside.

Show day

Turn on and final checks : 1h time slot before show.

After show

Projector dismantling directly after projection.

Total dismantling after projection of the day after, depending on context.

LOCATION REQUIREMENTS

- Space for the audience to gather in front of the projection.
- A white or clear colored wall for the projection.
- Controlled light pollution : possibility to dim or cover lamps close to the projection wall, turn off any lamp beaming on the projection wall, (if outside) close window blinds or turn off lights inside the projection building during show.
- Standing areas and (if possible) cozy seating areas.
- Ideally, space to put the technical equipment close to the audience area so the artists can speak with the audience easily.

SECURITY

Security is required if the equipment is kept in the public space overnight. Depending on the location and event duration, we can require a secured storage space close to the projection site to store the projector and video equipment at night.

TECHNICAL SUPPORT

We ask the organizer to provide technical support to ensure the project success : access to electricity and internet, possibility to cut off lamplights, support for installation, tests and dismantling. Technical support during show hours in case of external problems (electricity, ...).

CONTACT

Maxime Touroute

[+336 50 84 74 19](tel:+33650847419)